

Gas Regulator Included

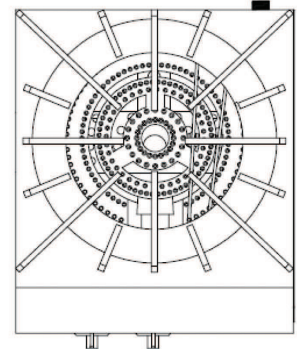
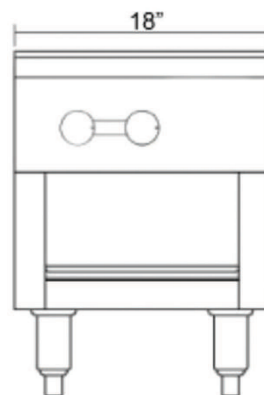
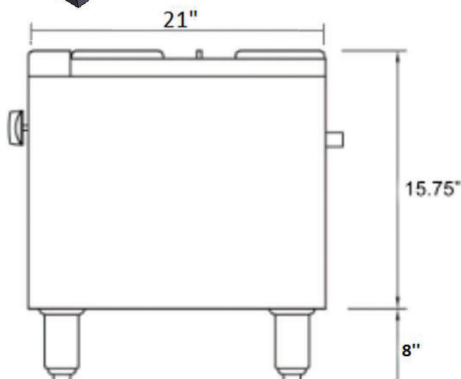
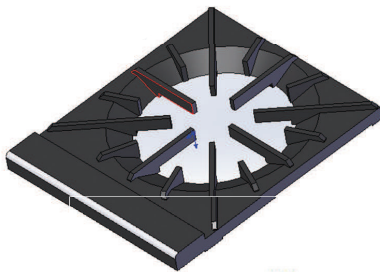

Model
VSP-1

STANDARD FEATURES

- Stainless steel construction
- Heavy duty 1-7/8" thick removable cast iron top grate
- 3-ring cast iron burner
- Dual control valves
- 2 standing pilot lights for instant ignition
- 8" adjustable legs
- Removable crumb tray for easy cleaning
- 3/4" rear NPT gas inlet, pressure regulator supplied

Warranty: Vionet limited parts and labor warranty takes effect from 1 year after end user purchase.

COMMERCIAL COOKING

MODEL	Burners	External Dimensions			Total BTU's		Crated Weight (lbs)
		W	D	H	Natural	LP	
VSP-1	1 (3 ring, 2 velves)	18	21	24	80,000	80,000	145

- A convertible 3/4" NPT appliance pressure regulator is provided with this unit and set for:
Natural Gas 4.0" W.C.
Propane Gas 10.0" W.C.
- If using a commercial flec it must comply with ANZI Z 21.69
- All equipment is supplied for LP (Propane) Gas, natural conversion kit isn't included.

- Rear Gas Connections is 3/4" NPT
- Recommended incoming pressure:
Natural Gas 4.5" W.C. with not more than a 1/2" W.C. pressure drop
LP Gas 10.5" W.C. with not more than a 1/2" WC. pressure drop