



## STANDARD FEATURES

### Service carts:

- 18 GA. 430 Stainless Steel shelves.
- 16 GA. 430 Stainless Steel angle support & handle.
- 4" casters, 2 with brakes.

### Sheet pan rack:

- 20 pan capacity 18" x 26"
- 18 GA. Aluminum tubing 1" x 1"
- 18 GA. Aluminum angle slides on 3" centers.
- 5" polyurethane swivel casters.
- Knock-down.

### Sheet pans:

- 20 GA. Aluminum solid sheet pan.
- 20 GA. Aluminum perforated sheet pan.

MODEL	DIMENSIONS	SHELVES	ANGLE SUPPORT	CASTERS	BRAKES	SHEET PAN
VIOCART1932KD	19"X31"X34"	18GA 430 S/S	16GA 430 S/S	4"	2	N/A
VIOASPR20KD	20.25"X26"X69"	N/A	18GA ALUMI-NUM	5"	N/A	20 SHEET PAN CAPACITY
VIOSBP1813A20	18"X13"X1"	N/A	N/A	N/A	N/A	20GA SOLID ALUMINUM
VIOSBP1826A20	18"X26"X1"	N/A	N/A	N/A	N/A	20GA SOLID ALUMINUM
VIOPBP1813A20	18"X13"X1"	N/A	N/A	N/A	N/A	20GA PERFORATED ALUMI-NUM
VIOPBP1826A20	18"X26"X1"	N/A	N/A	N/A	N/A	20GA PERFORATED ALUMI-NUM

DIMENSIONS/MODEL	VIOSBP1813A20	VIOSP1826A20	VIOPBP1813A20	VIOPBP1826A20
A	13"	26"	13"	26"
B	18"	18"	18"	18"

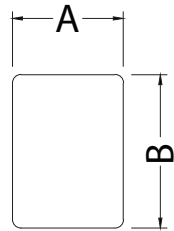

VIOSBP1813A20

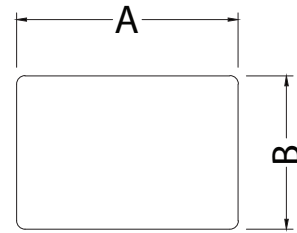

VIOPBP1826A20

DIMENSIONS/MODEL	VIOASPR20KD
A	20"
B	26"
C	69"

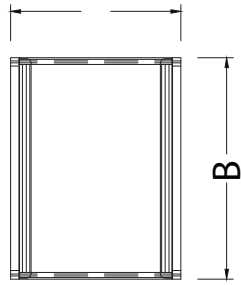
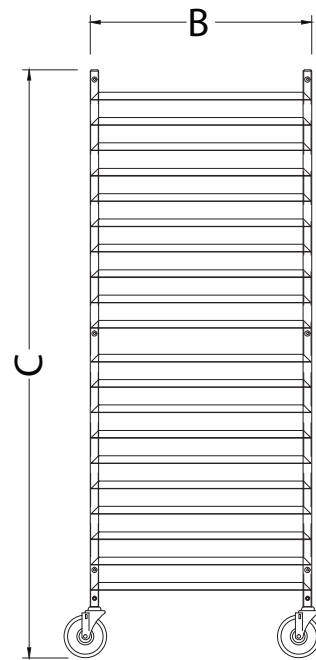
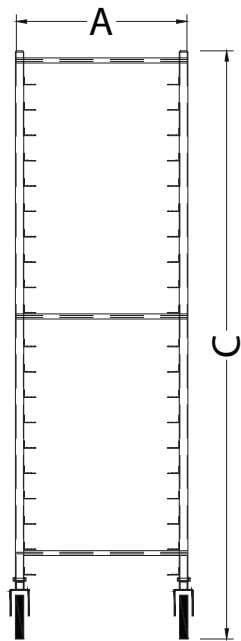
**VIOSASPR20KD**

DIMENSIONS/MODEL	VIOCART1932KD
A	31"
B	19"
C	34"

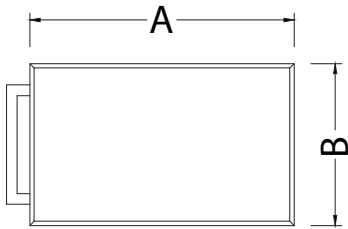

VIOCART1932KD

